

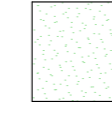

ZGRADA 2- Lovrečica

TLOCRT PRIZEMLJA

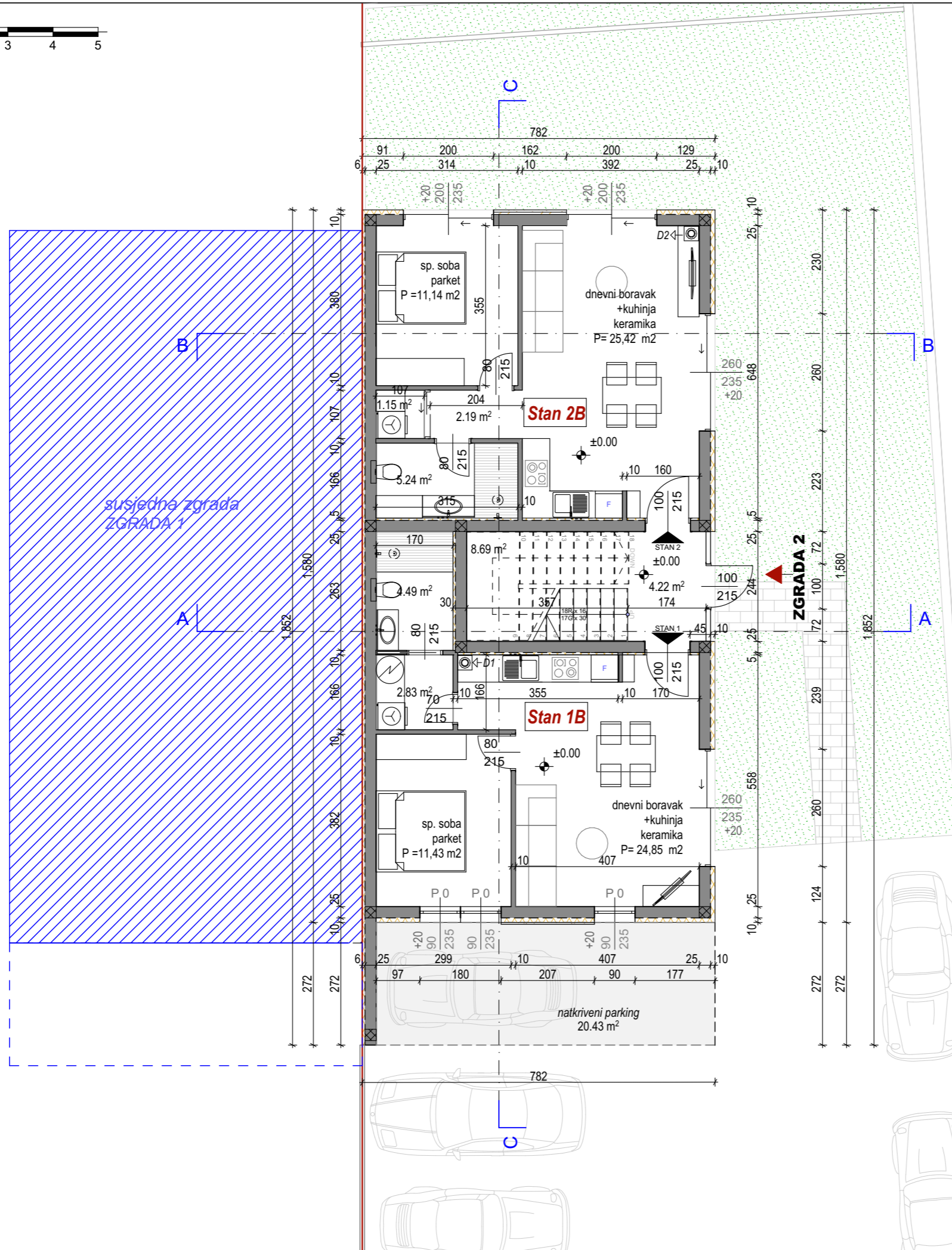

ZELENE POVRŠINE

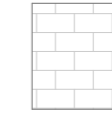

KAMENO ILI KERAMIČKO POPLOČENJE

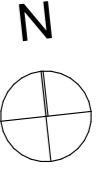

STAN 2-B

- dnevni boravak i kuhinja = 25,42 m²
- predprostor = 2,19 m²
- soba 1 = 11,14 m²
- izba = 1,15 m²
- kupaona = 5,24 m²
- ukupno = 45,14 m²

SVEUKUPNO = 45,14 m²



STAN 1-B

- dnevni boravak i kuhinja = 24,85 m²
- soba 1 = 11,43 m²
- izba = 2,83 m²
- kupaona = 4,49 m²
- ukupno = 43,60 m²

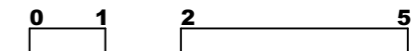
SVEUKUPNO = 43,60 m²



±0.00 = AP KOTA 14,60

TLOCRT PRIZEMLJA		
INVESTITOR	KALENDER EKREM, OIB: 43225964302 FRATRICI 62G, MURINE 52470, UMAG	glavni projekt
ZAHVAT	Poluugrađena višebitelska građevina	br.projekta XXIV-13/24
LOKACIJA	nova k.č.1620/31, k.o. Lovrečica (nastaje od dijela k.č.1620/31, k.o. Lovrečica)	MJ 1:100
PROJEKTANT	Sanja Petrić, dipl.ing.arh.	
GL.PROJEKTANT	Sanja Petrić, dipl.ing.arh.	
 URED OVLAŠTENOG ARHITEKTA - Rovinj Ovlaštena arhitektica Sanja Petrić dipl.ing.arh.		 SANJA PETRIĆ dipl.ing.arh. OVLAŠTENA ARHITEKTICA A 3089
Rovinj I/2025		4